

# debbie fortune

ESTATE AGENTS

## Bramley Square, Congresbury

£325,000

3 1 3



**CENTRAL VILLAGE LOCATION** - Tucked away in Bramley Square is a wonderful three bedroom property conveniently located within the heart of Congresbury and just a stone's throw away from all the village amenities.



## Key Features

- Three good sized bedrooms
- Off street parking
- Low maintenance garden
- Churchill School catchment area
- Council tax band B
- Dual aspect living room
- Loft conversion
- Central village location
- Maintenance charge £200 per annum and ground rent charge £10 per annum
- EPC rating C

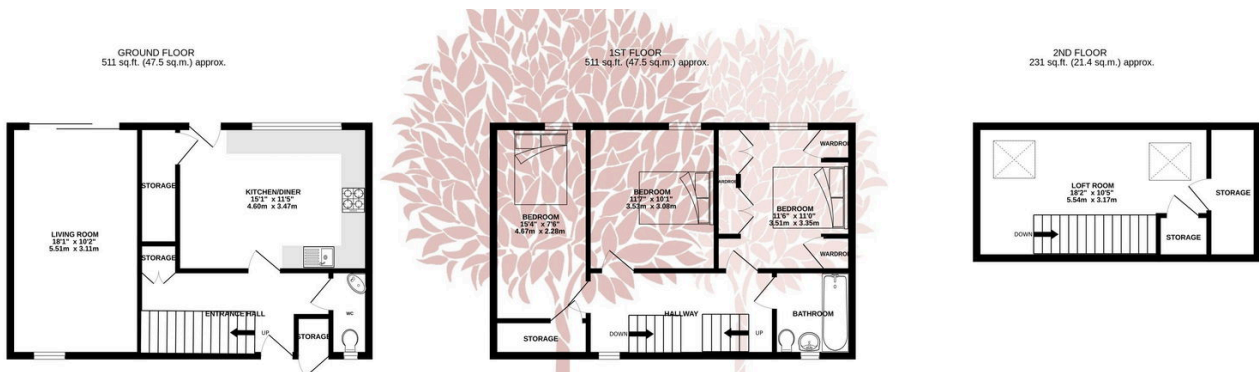

TOTAL FLOOR AREA: 1253 sq.ft. (116.5 sq.m.) approx.

Whilst every attempt has been made to ensure the accuracy of the floorplan contained here, measurements of doors, windows, rooms and any other items are approximate and no responsibility is taken for any error, omission or mis-statement. This plan is for illustrative purposes only and should be used as such by any prospective purchaser. The services, systems and appliances shown have not been tested and no guarantee as to their operability or efficiency can be given.

Made with Metropix ©2024

